



LAST REMAINING SUITE

RiverCourt

The Meadows Business Park
Camberley

Flexible lease available : 3,218 sq ft (299 sq m)



RiverCourt

The Meadows Business Park

An outstanding office building



LOCATION

Accessibility is often the key element of an occupier's aspirations. The Meadows provides so much more. With a combination of high profile neighbouring corporate occupiers, a highly trained workforce and excellent amenities, The Meadows is simply **the place to be**.

THE MEADOWS

The Meadows Business Park is a stunning office development in one of the most sought after business locations in the United Kingdom. It is easily accessible from the M3 motorway and combines excellent prominence with structured landscaping, to offer a strong and highly visual corporate profile to occupiers.

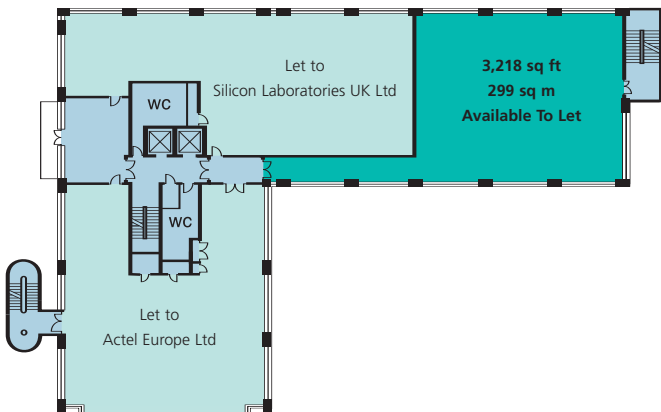
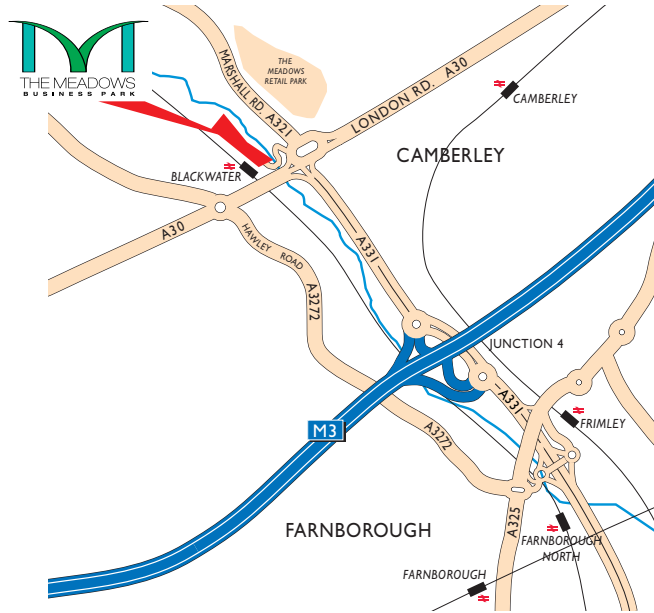

SPECIFICATION

- Column free floor space
- Impressive reception area with security
- Suspended ceilings with category 2 light fittings
- Four pipe fan coil air conditioning
- Fully accessible raised floors
- Two 13 person passenger lifts
- Shower facilities with lockers
- 14 car parking spaces at ratio of 1:228 per sq ft net on office areas
- Storage available from 750 sq ft
- Extensive landscaping throughout
- Riverside view



NET INTERNAL FLOOR AREAS

Part ground floor	3,218 sq ft	299 sq m
Reception	459 sq ft	43 sq m
Car spaces	14	

VIEWING

Strictly by appointment through the joint sole agents.

www.themeadowsbp.com